



CENTRAL DAKOTA GEM AND MINERAL SOCIETY  
Ida Mae Ramberg, Editor  
1325 N. 15th Street  
Bismarck, North Dakota 58501



# DIGGIN'S FROM DAKOTA

## CENTRAL DAKOTA GEM AND MINERAL SOCIETY



- AIMS:**
1. The study of Mineralogy and Geology.
  2. To foster field trips to collect minerals, gems, and fossils.
  3. The improvement of the members in the art of cutting, polishing and mounting gem material.
  4. To provide opportunity for exchange, purchase, and exhibition of specimens and material.

**MEETINGS:** First Sunday of each month in the Hospitality Room of the Capital Electric Building on Highway 83, north of Bismarck.

**VISITORS ARE ALWAYS WELCOME:** at the club functions, meetings, field trips, Annual Shows, etc.

### OFFICERS AND COMMITTEE CHAIRMEN:

|                        |                    |                    |            |                |
|------------------------|--------------------|--------------------|------------|----------------|
| President              | William A. Buresh  | 1527 N. 19th St.   | Bismarck   | 223 0611       |
| Vice President         | Duane Robey        | 2119 Ave. F East   | Bismarck   | 255 0576       |
| Secretary              | Stanley Fairaizl   | 205 6th Ave. N.W.  | Mandan     | 663 9712       |
| Treasurer              | Dick Bergantine    | 703 12th Ave. NW   | Mandan     | 663 3419       |
| Past President         | Earle Campbell     | 1134 28th St. N.   | Bismarck   | 255 3658       |
| Parliamentarian        | Genevieve Buresh   | 1527 N. 19th St.   | Bismarck   | 223 0611       |
| Program Chairman       | Duane Robey        | 2119 Ave. F East   | Bismarck   | 255 0576       |
| Librarian              | Owen O'Neill       | 906 1st Ave. NW    | Mandan     | 663 3748       |
| Field Trip Chairman    | Ewald Muggli       | Box 27             | Glen Ullin | 348 3897       |
| Nominations            | John Dosch         | 1425 N. 15th St.   | Bismarck   | 255 1924       |
| Refreshments           | Emma Brady         | 1401 Sunny Road    | Mandan     | 663 3904       |
| Annual Show            | Earle Campbell     | 1134 N. 28th St.   | Bismarck   | 255 3658       |
| Historian              | Vian Anderson      | R.R. #2            | Bismarck   | 673 4585       |
| Doorman and Greeter    | Ole Stavem         |                    | Wilton     | 734 6933       |
| Pebble Pup Leaders     | Pat & Harold Brady | 1401 Sunny Road    | Mandan     | 663 3904, 3901 |
| Publicity              | Blossomae Campbell | 1134 N. 28th St.   | Bismarck   | 258 3658       |
| Editor                 | Ida Mae Ramberg    | 1325 N. 15th St.   | Bismarck   | 223 6296       |
| Membership Chairman    |                    |                    |            |                |
| & Subscription Agent   | Larry Strand       | 913 1/2 N 19th St. | Bismarck   | 258 5128       |
| Federation Represent.. | Ernest Knudson     | 2020 Catherine Dr. | Bismarck   | 255 4796       |

**ZIP CODES**                      Bismarck, 58501                      Mandan 58554                      Glen Ullin 58631

All contributions for this Bulletin should be mailed to the Editor, Ida Mae Ramberg 1325 N. 15th Street, Bismarck, ND 58501, by the tenth of each month.

Each member should consider submitting articles etc. for publication each year.

Other editors may reprint articles from this bulletin. A credit line would be appreciated. Exchange bulletins are welcomed and should be mailed to the editor at her home address.

**DUES:** \$5.00 per family; **SUBSCRIPTIONS** to DIGGIN'S FROM DAKOTA: \$3.00 a year.

**ADVERTISING:** \$2.00 per month; \$11.00 for six months; \$22.00 for a year, in advance.

The Central Dakota Gem and Mineral Society is a member of the Rocky Mountain Federation of Mineralogical Societies and the American Federation of Mineralogical Societies.



# North Dakota's Annual GEM AND MINERAL SHOW

Mandan Community Center

Sept. 11 & 12, 1975

PRESIDENT'S COMMENTS

Uniformity is always an eye-catcher. If Harold Brady's idea and efforts prevail, the uniform cases of our society members should add another plus to the show this fall.

For the benefit of those of you who were not at the March meeting, Harold displayed a show case which he constructed and which he can set up or take down in five minutes. It is an upright case with hinged seams and a glass front which may be taken out by removing just two screws. This will allow the rest of the case to fold up into one flat package. This provides for easy handling, transportation, and storage.

Material for the case was estimated to cost about twenty-five dollars, and Pius Fischer has offered to build them for those members who wish to have them made---for a small fee of course. Directions for making the show case are included elsewhere in this newsletter. For further details, contact Harold Brady.

Harold is encouraging every member of the Society to exhibit specimens in an upright case. The show chairman, Earle Campbell, and I are one hundred percent behind him in this venture. It appeared that those present were all favorably impressed. Thank you, Harold, for a good idea and a fine presentation.

Something else along the same line---Anna Herr has considerable glass shelving which she says may fit right into the case in discussion or may be used for other types of displays. It may be had for the asking. See Mrs. Herr at the next meeting or contact her at the Herr Rock Shop in Dickinson.



**Forget what you ought not to remember; Remember what you ought not to forget.**

OFFICIAL NOTICE

A revised constitution will be acted upon for adoption at the APRIL meeting. The input of all members is urgently solicited.



**Please bring your copy of the new Constitution to the April Meeting- the 4th at 7:30 P.M.**

**DUES!** This is a reminder that according to Society policy, only members who have paid 1976 dues will be retained on the Society's roster beginning April 1. This will include the DIGGIN'S FROM DAKOTA mailing list. If your dues are delinquent, this will be the last issue of the newsletter that you will receive.

Bill Buresh



Courage is-- Being afraid yet pushing on.

**NEWS ITEMS FOR APRIL WILL BE DUE ON APRIL 4- OUR MEETING DATE, AS YOUR EDITOR MUST GET THE PAPER OUT BEFORE THE TENTH!!!!!! Call, Drop in mail, but get something to the EDITOR!!!!!!**

## TID BIT DIGGIN'S FROM THE MARCH MEETING

Visitors at the March meeting were Ken Ness of Washburn, and Don Wandler with his three daughters from Bismarck. We hope they return for another visit and join our group.

Members who paid dues in March and should be added to your lists are:

Mr. & Mrs. J. E. Martinek, Box 123, Mandan, ND ( ) 663 8857

Mr. & Mrs. Harold Larson, Box 182, Mandan, ND 58554 ( ) 663 6148

Phillip and Henry Solberg, Route 1, Bismarck, ND. 58501

The Executive Board had met and suggested giving rocks or minerals to hospitalized members instead of flowers. The Club voted to do this. Stanley Fairaizl will deliver in Mandan and Emma Fischer will deliver in Bismarck. Arrangements will be made for members in outlying towns- probably after they are home. It is everybody's responsibility to let Emma and Stan know of hospitalized members.

The president, Bill Buresh, had prepared a list of names with a grid to mark preferences of fossils, cabs, minerals, lapidary, or other. This was passed around to be checked. Members are asked to contribute to the "Hospital Rock Bank" to be used for this purpose.

Earle Campbell, show chairman, told of planning progress of the September 11, 12 Show. He is attempting to get a special attraction. He also announced that the state show has been placed on the agenda in the March issue of LAPIDARY JOURNAL.

At the show there will be nine dealers, at least two or three demonstrators, and 200 spaces for exhibitors- so all members are urged to have displays, along with the many that will be brought in.

Thank yous were read from Pius and Emma Fischer and Blossomae Campbell. It was good to see them at the meeting and wish them continued recuperation.

Marjorie Pederson called your editor and wished her to give you this message. We wish her well.

"I wish to thank the Central Dakota Gem and Mineral Society for remembering me with flowers while I was in the hospital. It's great to know that you have friends at a time like this. I can write now, but will use this media to tell how much it meant to me." Marjorie Pederson

We missed the fact that Mrs. John Dosch had a painful sprained wrist at the time of the February meeting. It is hoped that all is well now.

The Constitution Committee, consisting of Genevieve Buresh, Stanley Fairaizl, and Earle Campbell drafted a revised constitution. It was presented by Genevieve Buresh. Members are urged to read it and compare. It will be acted on at the April meeting. Those not in attendance at the March meeting should make an effort to see it in order to vote for passage or rejection. They have worked hard to get this to the members.

A request was made by Virgil Hill for the use of the NDG&MS slide show in South Dakota. They will also be used by Ida Mae Ramberg at the Retired Teachers' meeting in May. These were taken by the members, mostly Stanley Fairaizl, with script run off by Ida Mae Ramberg many years ago. They are on file in the Rocky Mountain Federation library of loanable slide programs.

There were 39 adults, 5 teens and 10 pebble pups as well as the guests, in attendance. Some of the winter absentees may be back next time----

The door prize, a cameo brooch, given by Mr. & Mrs. Pius Fischer, was won by Mrs. Anna Herr.

The lunch was served by Rosa Theis, Vina Anderson, and Verna Giese. Hostesses for April will be Katherine Muggli, Katie Anderson, and Nettie Nelson.

The program consisted of silent auction. The program for April will be on the Alaskan Earthquake-- at 7:30 P.M.

*Always There**There is no night, however dark,**That never ends in dawn;**There is no snow, however white**That stays when winter's gone.**There is no barrier too high**To intercept my prayer;**And there's no place**I'll be alone,**For God is always**there.**-Florence French*

The Central Dakota Gem and Mineral Society wishes to extend sincerest sympathy to those who have lost loved ones this month. The ones we know of are listed here.

\* Genevieve Buresh lost a sister, Helen Wobig, who had been in the hospital in Dickinson.

\*\* Pius Fischer lost a brother and nephew-in-law. Mike Fischer was a member of our group at one time. He passed away in California, while he and his wife were on a visit to their children. While there, Mike's daughter, Darlyne's husband, Hilary Hoffman, also passed away. The double funeral was held in La Mirada, March 16, and Mike's funeral was March 18 in Bismarck.

\* Kent Higgins' father passed away March 3. Milton K. Higgins was a well known figure in law circles.

\* Vernie Peterson was planning on a visit to his brother, but before he could go to see him, the brother passed away.

## DISPLAY AT BISMARCK PUBLIC LIBRARY

Vernie Peterson will have a display of gems, minerals and polished stones at the library for the next two weeks. Try to see them.

To the right is a copy of the new calling card of the club.



Central Dakota  
Gem and Mineral Society

Bismarck - Mandan Area

Meets first Sunday of Month  
Capital Electric Building

APRIL TO OCTOBER - 7:30 PM  
NOVEMBER TO MARCH - 2:30 PM

EARLE H. CAMPBELL

BLOSSOMAE CAMPBELL

CAMPBELL  
ENTERPRISES

Rough Rocks - Gem Stones

1134 North 28 Street  
Bismarck, North Dakota 58501

Phone  
255-3658

RAIN OR SHINE  
← COME TO →



Mont. Agate - Mont. Wonderstone  
N. D. Agatized Wood - Turtillo Agate  
Slabbed Agate - Bookends - Agate - Cabs.  
Australian Marine Agate  
India Agate

LAPIDARY & ROCK SHOP  
FRANK & ANNA HERR

Phone 225 8712  
528 W. Villard St.

Old Highway 10 & 94 Loop  
Dickinson, N. D. 58601

Harold Brady demonstrated this show case at the March meeting. He and his son did the diagram. Plus Fischer will make some of them, on order. They are collapsible so convenient for storing.

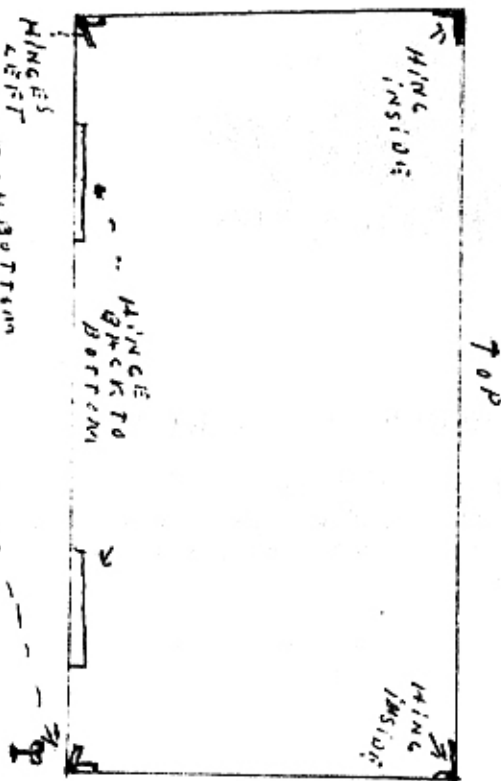
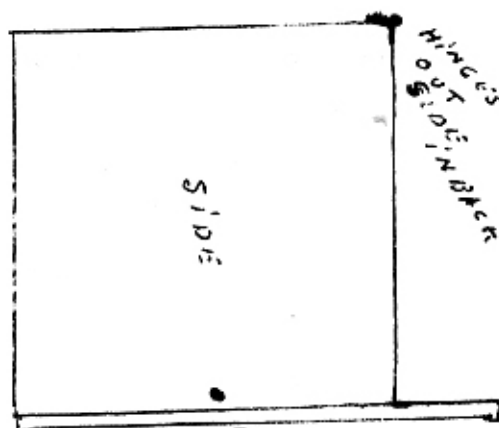
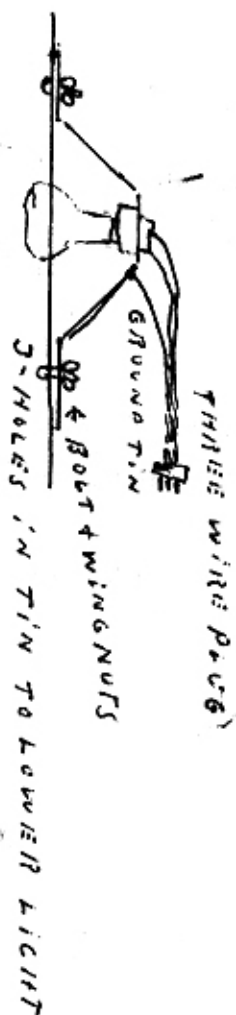
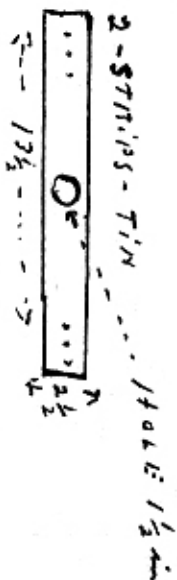
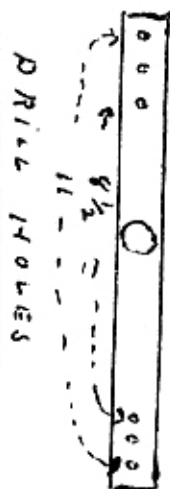

DRILL HOLES FOR SCREWS  
FOR MOUNTING

- 1-SHEET PLYWOOD
- 3/8-4x8
- 1-PIECE PLYWOOD
- 32in x 4ft
- 8ft 1x2
- 4ft 3/4x3/4
- 16 HINGES
- 1-DOUBLE STRENGTH
- GLASS-21 1/8 x 43 3/4
- 2 PIECES-TIN
- 13 1/2 x 2 1/2
- 2 PORCELAIN SOCKETS
- 2 SPRINGS-PLUGS
- 4ft wire
- BOLT & WING NUTS
- SCREWS

ASSEMBLE CASE ON SIDE - FOR MOBILE INFORMATION

CALL BRADY  
663-3903 - 663-3904

APPROX: PRICE - 30.00



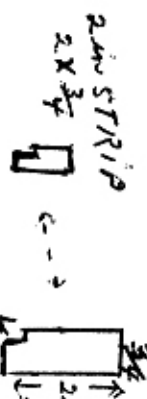
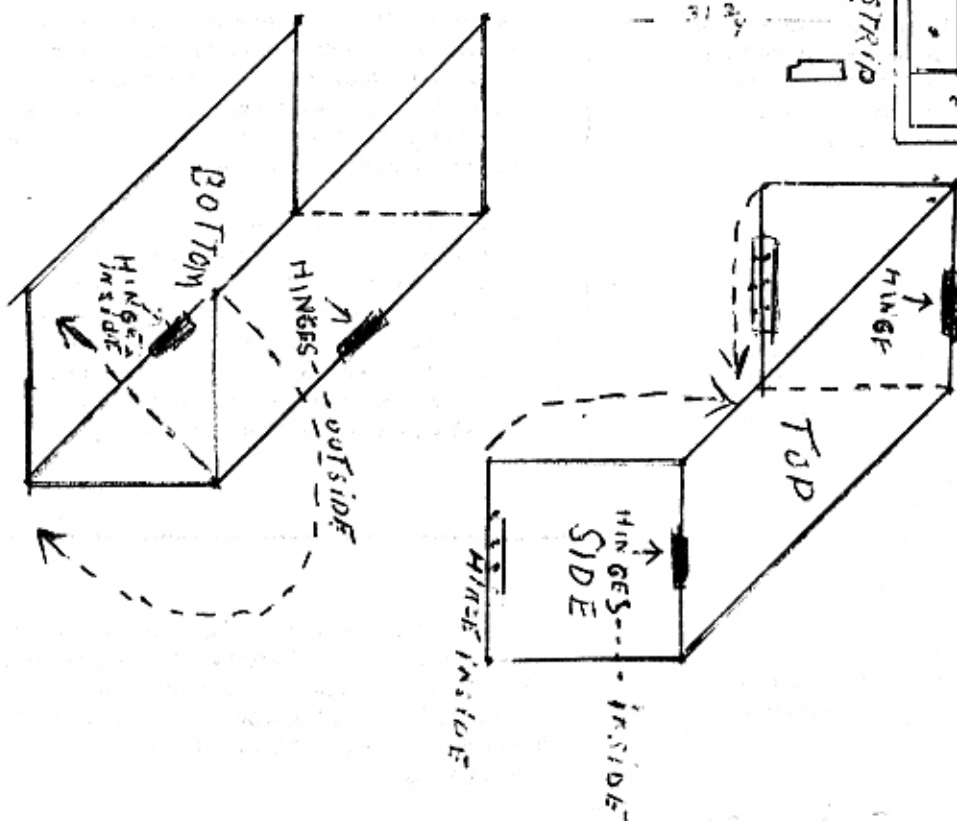
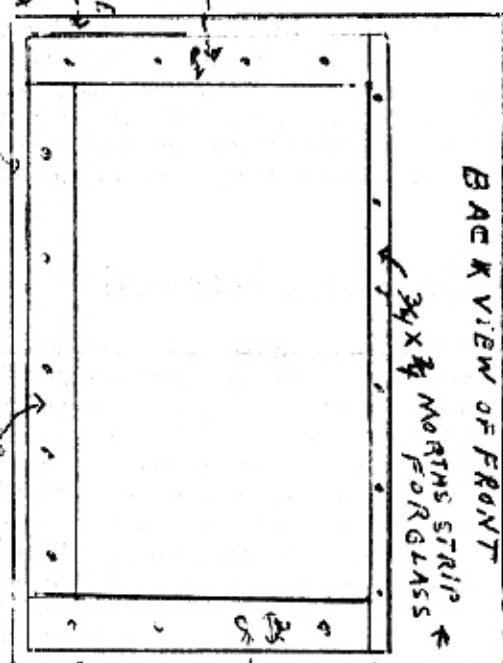
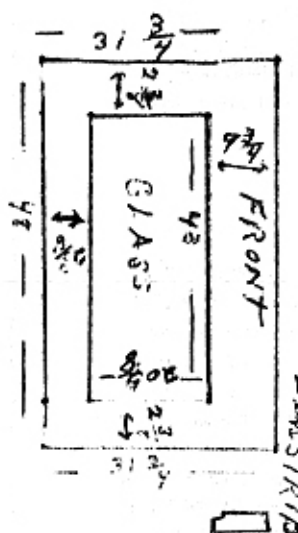

## THIS PAGE FROM THE APRIL AFMS NEWSLETTER

## RECENT DISCOVERIES

*The Oshkosh (Wisconsin) Quarrier* prints an item about the exciting scientific discovery in west central Africa of a burned out natural nuclear reactor. French scientists believe it may have caused mutations in the plant and animal life of the region about 2 billion years ago. Work has stopped at the area of the open pit uranium mine for investigation of the spontaneous reactor which is the only known natural atomic pile. Henry Chauvet, chief geologist of the mine, said the reactor was started by unknown causes and burned with a cataclysmic effect on the environment for more than a million years but that radioactivity from the spontaneous fission has long since disappeared.

*The Rockfinder* (Michigana Rock and Gem Club) reports that Dr. Bruce Raemsch, anthropologist from Hartwick College, Oneonta, New York and his archeological team have recently found a hand ax and several other ancient tools at a dig near Cobleskill, New York which are thought to be 70,000 years old. In earlier digs Dr. Raemsch discovered 30,000 year old tools.

## EDUCATIONAL PROGRAMS

A club particularly active in the educational aspects of the hobby is the Colorado Springs Mineralogical Society. The club members are concentrating on the mineral, gem and fossil deposits of their own area. Their prospecting and collecting are scientifically done, and their records are available in pictures as well as in writing. Their program on *Florissant Pegmatites* has been popular everywhere it is shown. Another of their professional quality programs is about the legendary gold town, Cripple Creek. The club is almost finished with a documentary on the *Florissant Fossils* and is sixty percent or more through with a comprehensive program on Colorado minerals. Many clubs could produce similar programs even if their area is not as richly blessed as Colorado Springs.

## A SAD TALE!

*from Michigan Gem News*

A whole row of perfect marcasite snails from near Pekin, Illinois, completely disintegrated into dust. Some had been sprayed and some had not. Only two, preserved in mineral oil, survived!

Marcasite, never a stable mineral, used to last well in dry pollution-free climates. This seems no longer true.

## SHOP HINT

Garbage can liners make good aprons when cutting and polishing rocks. Cold cream on the hands will help get the oil off if you put it on before you start to cut.

*via Gem Time*

## DON'T OVERLOOK WHAT'S NEAR AT HAND!

*By Russell MacFall*

Since shows seem to be the way of life of our mineral and lapidary clubs and since they seem (to judge from the bulletins) to run into something of a pattern from year to year, how about a new approach? A lively-minded associate has suggested that the best idea he has had along this line is to have a show dedicated and limited to minerals and fossils of the state in which the club exists. There is one overriding value to such a show. It will educate those who attend to the riches that nature has lavished on their state and give them a new interest in what lies at their doorstep. It might even suggest to some of the more open-minded that they join the club and join in the fun of field tripping with those who have already had some glimpses of the treasure at hand. Furthermore, it very likely would educate some of the club members and bring them into a more active association with the club's efforts.

Human nature being what it is, we all tend to undervalue what is easy to get and what is plentiful. Far horizons seem more delightful than those we see day by day, but this is a delusion. One of the strongest holds that the California federation has on its many clubs - one of the bases of its strength and vitality - is the interest it has excited in collecting in California and the neighboring states. Clubs elsewhere can profit from such an example, and it is not restricted to California for other examples could be cited.

Education is the excuse for our clubs and federations to exist. We give merit awards for excellence in service to the community and similar educational endeavors. Try a club show limited to what can come out of the cellars and show cases of members. Get some state speakers such as the state geologist and revel in local pride. Let the AFMS Newsletter hear from you if you try it!

George Cihacek, Editor of *The Loup Scoop* (Nebraska) says thirty-six out of the forty-two members of the Loup Valley Club are graduates of a rock and lapidary class sponsored by the Platte College Continuing Education Division. Schools all over the country will offer such courses if there are enough requests.